

Mating Pattern

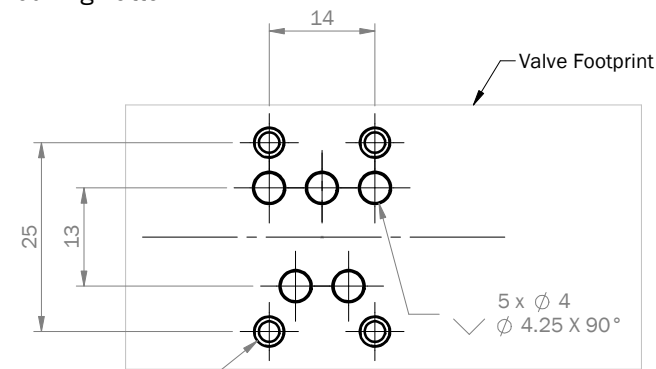

Recommended
4 x Ø 2.71
6-32 UNC - 3B ∇ 10
 ∇ Ø 3.98 X 90°

Recommended Mounting Surface Finish $0.4\mu\text{m}$

Notes:

1. Mounting screws: 6-32 x 1.25" SHCS are provided for mounting, Recommended Torque is 9.6 in.lbs
2. All elastomeric seals are FKM
3. M8 x 1mm connector compatible with Enfield Technologies Cable: A-CBL-M8-03P-F-XXXX

Standard Third Angle Projection
Units: mm
Unless specified otherwise:
Refer to ISO 2768-mK for tolerances
 Break Sharp Edges

Drawing Name: ELB-005-OUTL		5/3 Proportional Directional Valve	
Material: N/A	Finish: N/A	Drawn: S Wilhelm	Rev: A
Date: 12/20/19	Model: V05	Project:	Sheet 1 of 1
Size: A	Scale: 1:1		

ENFIELD TECHNOLOGIES
35 Nutmeg Drive
Trumbull, CT 06611
(203) 375-3100
www.enfieldtech.com
This information is proprietary to Enfield Technologies and may be further protected by trademarks, copyrights, or patents.